

**STEEL
INDOOR
D BOXES CSA 1.**

CAT. NO.	DIMENSIONS			Ship Wt (LBS.)	List Price
	H	W	D		
D-S-060603	6	6	3	2	11.80
D-S-060604	6	6	4	3	9.39
D-S-080804	8	8	4	4	12.40
D-S-101004	10	10	4	5	14.19
D-S-121204	12	12	4	7	17.42
D-S-181804	18	18	4	13	66.92
D-G-240604	24	6	4	11	61.94
D-G-360604	36	6	4	17	78.12
D-G-480604	48	6	4	22	92.77
D-G-600604	60	6	4	27	114.15
D-G-720604	72	6	4	32	149.82
D-G-240805	24	8	5	15	67.31
D-G-360805	36	8	5	22	91.75
D-G-480805	48	8	5	29	121.38
D-G-600805	60	8	5	36	135.80
D-G-720805	72	8	5	42	169.67
D-S-060606	6	6	6	4	23.71
D-S-080806	8	8	6	5	19.64
D-S-101006	10	10	6	6	20.87
D-S-121206	12	12	6	8	26.52
D-S-161606	16	16	6	14	55.82
D-S-181806	18	18	6	15	69.66
D-S-242406	24	24	6	28	148.93
D-G-181006	18	10	6	15	62.40
D-G-241006	24	10	6	19	78.17
D-G-361006	36	10	6	28	124.78
D-G-481006	48	10	6	36	128.55
D-G-601006	60	10	6	44	175.08
D-G-721006	72	10	6	53	211.97
D-S-161608	16	16	8	14	94.80
D-S-181808	18	18	8	20	88.71
D-S-242408	24	24	8	33	193.92
D-S-242410	24	24	10	37	211.43
D-G-302010	30	20	10	48	315.59
D-G-303010	30	30	10	65	393.59
D-G-362412	36	24	12	69	410.78

G - Galvanized

S - Powder Coated Gray

**ALUMINUM
INDOOR
D BOXES CSA 1**

CAT. NO.	DIMENSIONS			Ship Wt. (LBS.)	List Price
	H	W	D		
D-A-060603	6	6	3	2	24.25
D-A-060604	6	6	4	2	23.32
D-A-240604	24	6	4	5	67.42
D-A-360604	48	6	4	11	89.27
D-A-080804	8	8	4	3	28.55
D-A-101004	10	10	4	3	39.29
D-A-121204	12	12	4	4	52.54
D-A-240805	24	8	5	6	75.94
D-A-360805	36	8	5	10	103.53
D-A-480805	48	8	5	14	143.81
D-A-060606	6	6	6	2	30.47
D-A-120606	12	6	6	3	49.34
D-A-080806	8	8	6	3	45.22
D-A-101006	10	10	6	4	52.98
D-A-121206	12	12	6	5	68.37
D-A-181006	18	10	6	8	65.40
D-A-181806	18	18	6	15	90.14
D-A-241006	24	10	6	8	83.48
D-A-361006	36	10	6	14	133.27
D-A-481006	48	10	6	17	137.24
D-A-721006	72	10	6	26	226.35
D-A-241507	24	15	7	14	129.37
D-A-361507	36	15	7	19	164.68
D-A-481507	48	15	7	25	227.21
D-A-721507	72	15	7	35	305.71
* D-A-241809	24	18	9	17	156.76
* D-A-361809	36	18	9	24	262.57
* D-A-481809	48	18	9	31	270.35
* D-A-721809	72	18	9	44	325.27
D-A-302010	30	20	10	23	333.92
D-A-303010	30	30	10	30	436.85

* Depth of enclosures - 9.5"



**ECONOMY
E TYPE
HINGED BOXES - CSA 1.**

CAT. NO.	DIMENSIONS			Ship Wt. (LBS.)	List Price
	H	W	D		
E-S-060603	6	6	3	2	11.80
E-S-060604	6	6	4	3	9.39
E-S-080804	8	8	4	4	12.40
E-S-101004	10	10	4	6	14.19
E-S-121204	12	12	4	7	17.42
E-S-181804	18	18	4	17	66.92
E-S-080806	8	8	6	5	19.64
E-S-101006	10	10	6	6	20.87
E-S-121206	12	12	6	8	26.52
E-S-161606	16	16	6	14	55.82
E-S-181806	18	18	6	18	69.66
E-S-242406	24	24	6	34	148.93
E-S-161608	16	16	8	16	94.80
E-S-242408	24	24	8	38	193.92
E-S-242410	24	24	10	41	211.43



**CURRENT TRANSFORMER
CABINETS CSA 1.**

STEEL				Ship Wt. (LBS.)	List Price
CAT. NO.	H	W	D		
CT-G-301608	30	16.5	8	49	302.94
CT-G-302010	30	20	10	61	347.05
CT-G-303010	30	30	10	85	438.73
CT-G-421816	42	18	16	91	547.83
CT-G-423624	42	36	24	251	763.84
OPTIONAL NEUTRAL PAD FOR CT CABINETS - PAD-T-600					99.75
ALUMINUM				Ship Wt. (LBS.)	List Price
CAT. NO.	H	W	D		
CT-A-301608	30	16.5	8	24	326.93
CT-A-302010	30	20	10	29	364.36
CT-A-303010	30	30	10	41	460.71
CT-A-421816	42	18	16	44	593.64
CT-A-423624	42	36	24	115	835.30
OPTIONAL NEUTRAL PAD FOR CT CABINETS - PAD-T-600					99.75

BC HYDRO "L" PULL BOXES

CAT. NO.	SWITCH SIZE AMP	DIMENSIONS					List Price
		A	B	C	D	E	
DL-G-200	200	48	24	30	48	72	850.04
DL-G-400	400	62	24	30	48	86	913.62
DL-G-600	600-800	62	30	36	54	92	1020.05

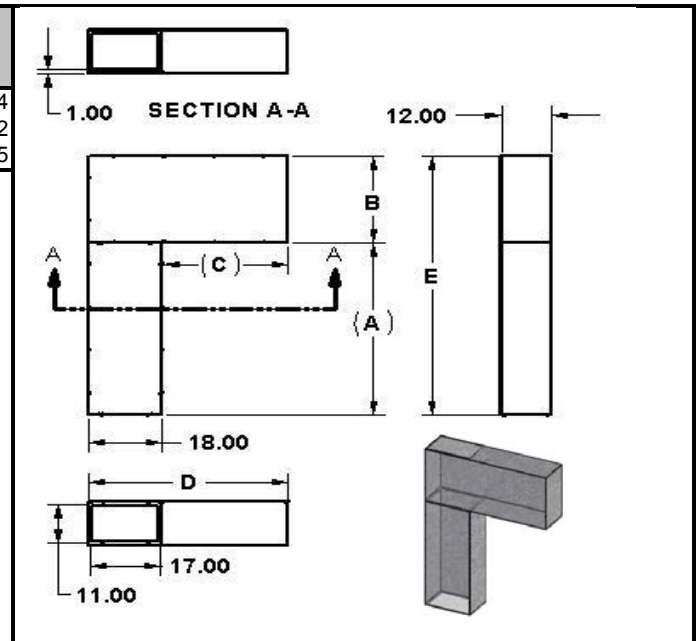



CHECK METER BOXES - CSA 1

100 Amp CAT. NO.	H	W	D	Ship Wt (LBS.)	List Price
CM-A-121206	12	12	6	5	113.60
CM-G-121206	12	12	6	8	107.95
125-200 Amps CAT. NO.	H	W	D	Ship Wt (LBS.)	List Price
CM-A-201408	20	14	8	9	203.11
CM-G-201408	20	14	8	19	192.93

225-400 Amps CAT. NO.	H	W	D	Ship Wt. (LBS.)	List Price
CM-A-302008	30	20	8	17	328.89
CM-G-302008	30	20	8	43	312.41
425-600 Amps CAT. NO.	H	W	D	Ship Wt. (LBS.)	List Price
CM-A-362410	36	24	10	31	447.32
CM-G-362410	36	24	10	64	424.96



**STEEL DWP
WEATHERPROOF BOXES CSA 3.**

CAT. NO.	H	W	D	(LBS.)	Price
D-WP-S-060603	6	6	3	2	43.64
D-WP-S-060604	6	6	4	3	44.89
D-WP-S-080804	8	8	4	4	50.04
D-WP-S-101004	10	10	4	6	58.91
D-WP-S-121204	12	12	4	7	69.60
D-WP-S-080806	8	8	6	5	60.64
D-WP-S-101006	10	10	6	7	74.86
D-WP-S-121206	12	12	6	10	81.88



**ALUMINUM DWP
WEATHERPROOF BOXES CSA 3.**

CAT. NO.	DIMENSIONS			Ship Wt. (LBS.)	List Price
	H	W	D		
D-WP-A-060603	6	6	3	2	78.90
D-WP-A-060604	6	6	4	2	78.99
D-WP-A-080804	8	8	4	3	108.15
D-WP-A-101004	10	10	4	4	124.63
D-WP-A-121204	12	12	4	5	140.38
D-WP-A-060606	6	6	6	3	80.54
D-WP-A-080806	8	8	6	4	119.25
D-WP-A-101006	10	10	6	5	126.06
D-WP-A-121206	12	12	6	5	167.93

***Call for other sizes



**INDOOR EH ALUMINUM
HINGED & HASP BOXES - CSA 1**

CAT. NO.	H	W	D	Ship Wt (LBS.)	List Price
E-A-060603	6	6	3	2	59.05
E-A-060604	6	6	4	2	60.41
E-A-080804	8	8	4	3	65.55
E-A-101004	10	10	4	3	75.42
E-A-121204	12	12	4	4	84.71
E-A-060606	6	6	6	2	67.24
E-A-080806	8	8	6	3	78.75
E-A-101006	10	10	6	4	87.24
E-A-120606	12	6	6	3	84.18
E-A-121206	12	12	6	5	104.12



**WEATHERPROOF EWP
ALUMINUM HINGED & HASP
BOXES - CSA 3**

CAT. NO.	H	W	D	Ship Wt. (LBS.)	List Price
E-WP-A-060604	6	6	4	2.0	96.82
E-WP-A-080804	8	8	4	3.0	132.71
E-WP-A-101004	10	10	4	3.0	152.88
E-WP-A-121204	12	12	4	4.0	172.07
E-WP-A-060606	6	6	6	2.0	100.00
E-WP-A-080806	8	8	6	3.0	146.29
E-WP-A-101006	10	10	6	4.0	154.65
E-WP-A-121206	12	12	6	5.0	205.96



**INDOOR WW ALUMINUM
WIRE WAYS - CSA 1**

CAT. NO.	H	W	D	Ship Wt (LBS.)	List Price
D-A-120503	12	5	3	2	42.85
D-A-180503	18	5	3	3	57.57
D-A-240503	24	5	3	4	72.01
D-A-360503	36	5	3	6	100.74
D-A-480503	48	5	3	7	133.84
D-A-600503	60	5	3	9	166.01
D-A-720503	72	5	3	10	199.14

**STEEL METER CABINETS
DOUBLE DOOR CSA 1 OR 3**

CSA	CAT. NO.	H	W	D	Ship Wt. (LBS.)	List Price
1	MC-S-242410	24	24	10	26	188.69
1	MC-S-271310	27	13	10	29	152.70
1	MC-S-302010	30	20	10	45	162.76
1	MC-S-303010	30	30	10	72	212.27
1	MC-S-363612	36	36	12	122	359.91
1	MC-S-484812	48	48	12	196	580.56
3	MC-WP-S-271310	27	13	10	45	255.88



ALUMINUM TRAILER BOXES CSA 3.

Amps	CAT. NO.	H	W	D	Ship Wt (LBS.)	List Price
125	TR-A-1	12	9	3 3/4	4	75.49
225	TR-A-2	14	11	4 1/2	5	138.10



PADS FOR TRAILER BOXES

Amps	CAT. NO.	Ship Wt. (LBS.)	List Price
125	PAD-TB-125	0.5	33.31
225	PAD-TB-225	0.5	43.60



ALUMINUM PAD TYPE SPLITTER TROUGHS CSA 1.

AMP	3 WIRE CAT. NO.	L	W	D	Ship Wt (LBS.)	List Price
125	PAD-A-2413	24	6	4	5	105.01
125	PAD-A-3613	36	6	4	9	117.96
125	PAD-A-4813	48	6	4	12	138.62
125	PAD-A-6013	60	6	4	14	191.68
125	PAD-A-7213	72	6	4	16	203.88
225	PAD-A-2423	24	8	5	7	143.42
225	PAD-A-3623	36	8	5	11	145.07
225	PAD-A-4823	48	8	5	15	179.94
225	PAD-A-6023	60	8	5	18	198.78
225	PAD-A-7223	72	8	5	23	217.43
400	PAD-A-3643	36	10	6	15	226.96
400	PAD-A-4843	48	10	6	18	242.16
400	PAD-A-6043	60	10	6	22	271.78
400	PAD-A-7243	72	10	6	27	299.37
600	PAD-A-4863	48	10	6	20	394.09
600	PAD-A-6063	60	10	6	22	458.46
600	PAD-A-7263	72	10	6	30	509.38

AMP	4 WIRE CAT. NO.	L	W	D	Ship Wt. (LBS.)	List Price
125	PAD-A-3614	36	6	4	8	156.62
125	PAD-A-4814	48	6	4	12	171.83
125	PAD-A-6014	60	6	4	15	229.89
125	PAD-A-7214	72	6	4	16	246.32
225	PAD-A-3624	36	8	5	11	204.86
225	PAD-A-4824	48	8	5	15	211.83
225	PAD-A-6024	60	8	5	19	244.40
225	PAD-A-7224	72	8	5	23	259.44
400	PAD-A-4844	48	10	6	18	326.68
400	PAD-A-6044	60	10	6	23	345.10
400	PAD-A-7244	72	10	6	27	370.78
600	PAD-A-4864	48	10	6	20	503.11
600	PAD-A-6064	60	10	6	23	569.51
600	PAD-A-7264	72	10	6	30	620.57

STEEL PAD TYPE SPLITTER TROUGHS CSA 1.

AMP	3 WIRE CAT. NO.	DIMENSIONS			Ship Wt (LBS.)	List Price
		L	W	D		
125	PAD-G-2413	24	6	4	10	84.18
125	PAD-G-3613	36	6	4	17	98.16
125	PAD-G-4813	48	6	4	20	116.44
125	PAD-G-6013	60	6	4	24	143.51
125	PAD-G-7213	72	6	4	33	165.03
225	PAD-G-2423	24	8	5	13	114.95
225	PAD-G-3623	36	8	5	22	116.96
225	PAD-G-4823	48	8	5	29	147.20
225	PAD-G-6023	60	8	5	40	171.48
225	PAD-G-7223	72	8	5	46	187.22
400	PAD-G-3643	36	10	6	28	181.86
400	PAD-G-4843	48	10	6	36	193.98
400	PAD-G-6043	60	10	6	50	218.11
400	PAD-G-7243	72	10	6	54	266.96
600	PAD-G-4863	48	10	6	37	315.61
600	PAD-G-6063	60	10	6	50	367.28
600	PAD-G-7263	72	10	6	53	408.02

AMP	4 WIRE CAT. NO.	DIMENSIONS			Ship Wt. (LBS.)	List Price
		L	W	D		
125	PAD-G-3614	36	6	4	17	122.97
125	PAD-G-4814	48	6	4	20	134.83
125	PAD-G-6014	60	6	4	24	179.74
125	PAD-G-7214	72	6	4	33	193.85
225	PAD-G-3624	36	8	5	22	154.38
225	PAD-G-4824	48	8	5	30	160.62
225	PAD-G-6024	60	8	5	40	192.25
225	PAD-G-7224	72	8	5	46	204.13
400	PAD-G-4844	48	10	6	36	248.02
400	PAD-G-6044	60	10	6	50	271.58
400	PAD-G-7244	72	10	6	55	291.62
600	PAD-G-4864	48	10	6	37	405.50
600	PAD-G-6064	60	10	6	50	459.48
600	PAD-G-7264	72	10	6	53	500.48

SPLITTER PADS FOR ABOVE:



CAT. NO.	Ship Wt.	List Price
PAD-T-125	0.5	31.17
PAD-T-225	0.5	40.53
PAD-T-400	0.5	60.79
PAD-T-600	0.5	99.75



CONTINUOUS BUS BAR GUTTERS CSA 1.

3 WIRE		L	W	D	LENGTH (FEET)	List Price
AMP	CAT. NO.					
400	BUS-A-0400-04-3	48	15	7	4	715.08
400	BUS-A-0400-05-3	60	15	7	5	850.31
400	BUS-A-0400-06-3	72	15	7	6	1003.61
400	BUS-A-0400-07-3	84	15	7	7	1141.31
400	BUS-A-0400-08-3	96	15	7	8	1376.57
400	BUS-A-0400-09-3	108	15	7	9	1511.73
400	BUS-A-0400-10-3	120	15	7	10	1673.19
400	BUS-A-0400-11-3	132	15	7	11	1827.48
400	BUS-A-0400-12-3	144	15	7	12	2021.00
600	BUS-A-0600-04-3	48	15	7	4	918.64
600	BUS-A-0600-05-3	60	15	7	5	972.63
600	BUS-A-0600-06-3	72	15	7	6	1058.65
600	BUS-A-0600-07-3	84	15	7	7	1253.23
600	BUS-A-0600-08-3	96	15	7	8	1431.49
600	BUS-A-0600-09-3	108	15	7	9	1603.14
600	BUS-A-0600-10-3	120	15	7	10	1775.64
600	BUS-A-0600-11-3	132	15	7	11	1980.12
600	BUS-A-0600-12-3	144	15	7	12	2150.32
800	BUS-G-0800-04-3	48	28.5	9	4	1004.68
800	BUS-G-0800-05-3	60	28.5	9	5	1216.78
800	BUS-G-0800-06-3	72	28.5	9	6	1342.44
800	BUS-G-0800-07-3	84	28.5	9	7	1629.50
800	BUS-G-0800-08-3	96	28.5	9	8	1893.16
800	BUS-G-0800-09-3	108	28.5	9	9	2161.39
800	BUS-G-0800-10-3	120	28.5	9	10	2413.69
800	BUS-G-0800-11-3	132	28.5	9	11	2676.82
800	BUS-G-0800-12-3	144	28.5	9	12	2956.50
1200	BUS-G-1200-05-3	60	28.5	9	5	1767.77
1200	BUS-G-1200-06-3	72	28.5	9	6	2014.91
1200	BUS-G-1200-07-3	84	28.5	9	7	2544.19
1200	BUS-G-1200-08-3	96	28.5	9	8	2964.34
1200	BUS-G-1200-09-3	108	28.5	9	9	3406.71
1200	BUS-G-1200-10-3	120	28.5	9	10	3783.66
1200	BUS-G-1200-11-3	132	28.5	9	11	4238.12
1200	BUS-G-1200-12-3	144	28.5	9	12	4664.11

4 WIRE		L	W	D	LENGTH (FEET)	List Price
AMP	CAT. NO.					
400	BUS-A-0400-04-4	48	18	9.5	4	1083.32
400	BUS-A-0400-05-4	60	18	9.5	5	1125.58
400	BUS-A-0400-06-4	72	18	9.5	6	1359.65
400	BUS-A-0400-07-4	84	18	9.5	7	1648.63
400	BUS-A-0400-08-4	96	18	9.5	8	1887.33
400	BUS-A-0400-09-4	108	18	9.5	9	2136.90
400	BUS-A-0400-10-4	120	18	9.5	10	2358.81
400	BUS-A-0400-11-4	132	18	9.5	11	2540.42
400	BUS-A-0400-12-4	144	18	9.5	12	2717.50
600	BUS-A-0600-04-4	48	18	9.5	4	1225.37
600	BUS-A-0600-05-4	60	18	9.5	5	1280.64
600	BUS-A-0600-06-4	72	18	9.5	6	1472.47
600	BUS-A-0600-07-4	84	18	9.5	7	1772.89
600	BUS-A-0600-08-4	96	18	9.5	8	2002.97
600	BUS-A-0600-09-4	108	18	9.5	9	2299.47
600	BUS-A-0600-10-4	120	18	9.5	10	2576.91
600	BUS-A-0600-11-4	132	18	9.5	11	2820.28
600	BUS-A-0600-12-4	144	18	9.5	12	3051.17
800	BUS-G-0800-04-4	48	35	11	4	1792.12
800	BUS-G-0800-05-4	60	35	11	5	1933.63
800	BUS-G-0800-06-4	72	35	11	6	2013.61
800	BUS-G-0800-07-4	84	35	11	7	2426.53
800	BUS-G-0800-08-4	96	35	11	8	2825.73
800	BUS-G-0800-09-4	108	35	11	9	3115.01
800	BUS-G-0800-10-4	120	35	11	10	3272.05
800	BUS-G-0800-11-4	132	35	11	11	3782.11
800	BUS-G-0800-12-4	144	35	11	12	4145.43
1200	BUS-G-1200-05-4	60	35	11	5	2882.83
1200	BUS-G-1200-06-4	72	35	11	6	3380.31
1200	BUS-G-1200-07-4	84	35	11	7	3930.95
1200	BUS-G-1200-08-4	96	35	11	8	4347.89
1200	BUS-G-1200-09-4	108	35	11	9	4909.53
1200	BUS-G-1200-10-4	120	35	11	10	5296.25
1200	BUS-G-1200-11-4	132	35	11	11	6133.03
1200	BUS-G-1200-12-4	144	35	11	12	6654.95



ALUMINUM BAR TYPE SPLITTER TROUGHS CSA 1.

3 WIRE		L	W	D	Ship Wt (LBS.)	List Price
AMP	CAT. NO.					
400	BAR-A-400-24-3	24	15	7	18	398.06
400	BAR-A-400-36-3	36	15	7	24	437.65
400	BAR-A-400-48-3	48	15	7	28	518.62
400	BAR-A-400-60-3	60	15	7	31	600.37
400	BAR-A-400-72-3	72	15	7	35	682.10
600	BAR-A-600-36-3	36	15	7	25	576.26
600	BAR-A-600-48-3	48	15	7	29	602.09
600	BAR-A-600-60-3	60	15	7	32	669.05
600	BAR-A-600-72-3	72	15	7	39	745.22

4 WIRE		L	W	D	Ship Wt. (LBS.)	List Price
AMP	CAT. NO.					
400	BAR-A-400-24-4	24	18	9.5	21	480.77
400	BAR-A-400-36-4	36	18	9.5	28	587.76
400	BAR-A-400-48-4	48	15	7	30	668.94
400	BAR-A-400-60-4	60	15	7	35	770.68
400	BAR-A-400-72-4	72	15	7	40	795.13
600	BAR-A-600-36-4	36	18	9.5	28	730.95
600	BAR-A-600-48-4	48	18	9.5	35	769.31
600	BAR-A-600-60-4	60	15	7	38	805.37
600	BAR-A-600-72-4	72	15	7	40	894.50



OCTAGON BOX COVERS



CAT. NO.	DESCRIPTION	Ship W (LBS.)	Min. Order Qty.	List Price
PL-5	5" DISC - painted white	0.5	50	4.03

ALUMINUM GANG BOXES - CSA 1

No. of Gangs	CAT. NO.	H	W	D	Ship Wt. (LBS.)	List Price
2	GB-A-02	4 1/4	4	2 1/4	1.0	19.27
3	GB-A-03	6	4	2 1/4	1.0	28.65
4	GB-A-04	7 3/4	4	2 1/4	1.0	30.19
5	GB-A-05	9 5/8	4	2 1/4	1.0	33.91
6	GB-A-06	11.5	4	2 1/4	2.0	43.87
7	GB-A-07	13.8	4	2 1/4	2.0	48.86

ALUMINUM GANG BOX COVERS

BLANK
SURFACE - SC
OR FLUSH - FC



CAT. NO.	No. of Gangs	Ship Wt (LBS.)	List Price
GB-SC-A-BLA-02	2	0.5	Please call for pricing
GB-SC-A-BLA-03	3	0.5	
GB-SC-A-BLA-04	4	0.5	
GB-SC-A-BLA-05	5	0.5	
GB-SC-A-BLA-06	6	0.5	
GB-SC-A-BLA-07	7	0.5	
GB-FC-A-BLA-02	2	0.5	
GB-FC-A-BLA-03	3	0.5	
GB-FC-A-BLA-04	4	0.5	
GB-FC-A-BLA-05	5	0.5	
GB-FC-A-BLA-06	6	0.5	
GB-FC-A-BLA-07	7	0.5	

SWITCH
SURFACE - SC
OR FLUSH - FC



CAT. NO.	No. of Gangs	Ship Wt. (LBS.)	List Price
GB-SC-A-SWI-02	2	0.5	Please call for pricing
GB-SC-A-SWI-03	3	0.5	
GB-SC-A-SWI-04	4	0.5	
GB-SC-A-SWI-05	5	0.5	
GB-SC-A-SWI-06	6	0.5	
GB-SC-A-SWI-07	7	0.5	
GB-FC-A-SWI-02	2	0.5	
GB-FC-A-SWI-03	3	0.5	
GB-FC-A-SWI-04	4	0.5	
GB-FC-A-SWI-05	5	0.5	
GB-FC-A-SWI-06	6	0.5	
GB-FC-A-SWI-07	7	0.5	



DUPLEX
SURFACE - SC
OR FLUSH - FC



CAT. NO.	No. of Gangs	Ship Wt (LBS.)	List Price
GB-SC-A-DUP-02	2	0.5	Please
GB-SC-A-DUP-03	3	0.5	call
GB-SC-A-DUP-04	4	0.5	for
GB-SC-A-DUP-05	5	0.5	pricing
GB-SC-A-DUP-06	6	0.5	
GB-SC-A-DUP-07	7	0.5	

CAT. NO.	No. of Gangs	Ship Wt. (LBS.)	List Price
GB-FC-A-DUP-02	2	0.5	Please
GB-FC-A-DUP-03	3	0.5	call
GB-FC-A-DUP-04	4	0.5	for
GB-FC-A-DUP-05	5	0.5	pricing
GB-FC-A-DUP-06	6	0.5	
GB-FC-A-DUP-07	7	0.5	



STAINLESS STEEL GANG BOX COVERS
(FLUSH MOUNT) - CSA 1.



DUPLEX

CAT. NO.	No. of Gangs	Ship Wt (LBS.)	List Price
GB-FC-SS-DUP-02	2	0.5	Please
GB-FC-SS-DUP-03	3	0.5	call
GB-FC-SS-DUP-04	4	0.5	for
GB-FC-SS-DUP-05	5	0.5	pricing
GB-FC-SS-DUP-06	6	0.5	
GB-FC-SS-DUP-07	7	0.5	

DECORA

CAT. NO.	No. of Gangs	Ship Wt. (LBS.)	List Price
GB-FC-SS-DEC-02	2	0.5	Please
GB-FC-SS-DEC-03	3	0.5	call
GB-FC-SS-DEC-04	4	0.5	for
GB-FC-SS-DEC-05	5	0.5	pricing
GB-FC-SS-DEC-06	6	0.5	
GB-FC-SS-DEC-07	7	0.5	

TELEPHONE / CABLEVISION DISTRIBUTION BOXES

CAT. NO.	DESCRIPTION	H	W	D	Ship W (LBS.)	Min. Order Qty.	List PRICE
C-PT6F	BC Cable Plastic-Surface				2.0	20	31.08
C-PWD6F	BC Cable Plastic-Flush				3.0	14	38.80
C-PWDSFL	BC Cable Plastic-Flush - Large				6.0	4	53.08
RB8-P-B	RB8 - Box Only				2.0	12	14.75
RB8-P-C	RB8 - Cover Only				1.0	12	18.86
T-PWD6S	BC Tel Plastic-Flush				3.0	14	40.69
T-PT6S	BC Tel Plastic-Surface				2.0	20	34.56
T-PWD6PA	Plastic Pipe Adaptor				0.5	14	2.78
T-PWDSTP	Plastic Trim Plate				0.5	14	5.38
TC-P-3000B	BC Telephone/Cable Base				3.0		58.31
TC-P-3000C	BC Telephone/Cable Lid and Frame				2.0		55.02



BUS BAR

CAT. NO.	DESCRIPTION	List Price per inch.
BB-A-0025x0100	Bus Bar Aluminum - 1/4 x 1	Please call
BB-A-0025x0150	Bus Bar Aluminum - 1/4 x 1 1/2	for pricing
BB-A-0025x0200	Bus Bar Aluminum - 1/4 x 2	
BB-C-0025x0100	Bus Bar Copper - 1/4 x 1	
BB-C-0025x0150	Bus Bar Copper - 1/4 x 1 1/2	
BB-C-0025x0200	Bus Bar Copper - 1/4 x 2	
BB-C-0025x0300	Bus Bar Copper - 1/4 x 3	
BB-C-0025x0400	Bus Bar Copper - 1/4 x 4	
BB-C-0025x0500	Bus Bar Copper - 1/4 x 5	
BB-C-0025x0600	Bus Bar Copper - 1/4 x 6	

* Please call for other sizes.

CUSTOM ENCLOSURES

CSA 1, 3, 4, 4X

COMPLETE CAD, DESIGN AND PROTOTYPING AVAILABLE
CALL FOR QUOTATION

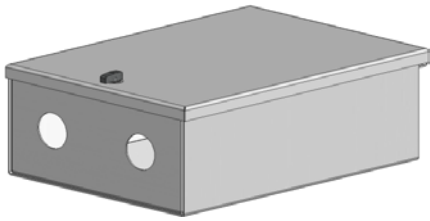

Consolidation Box

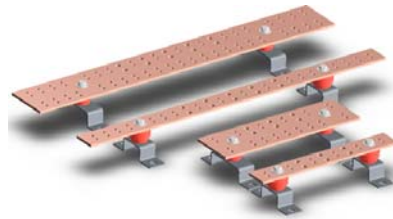

Grounding Busbar

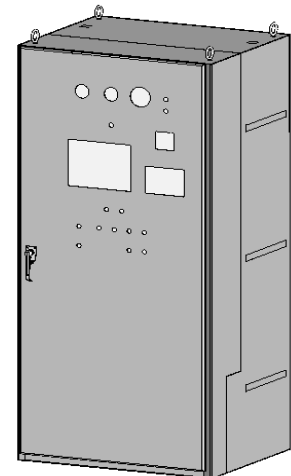
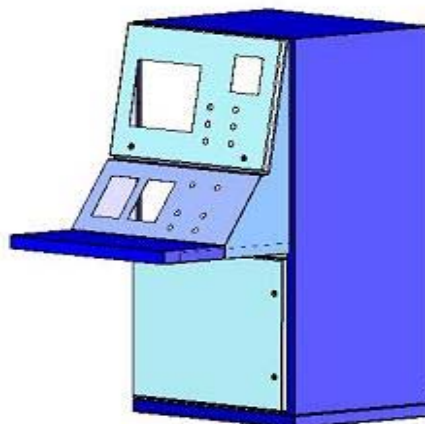
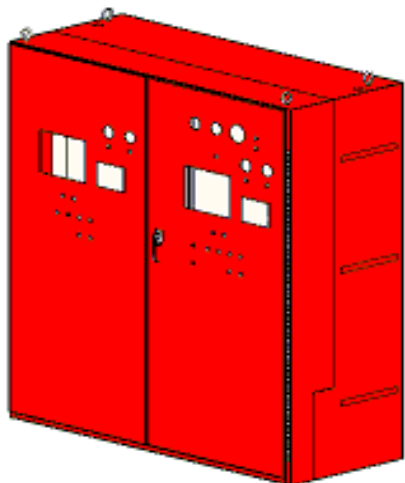
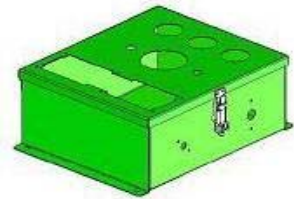
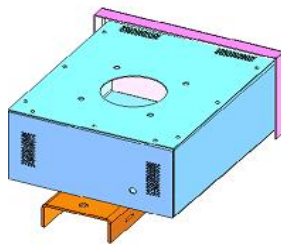
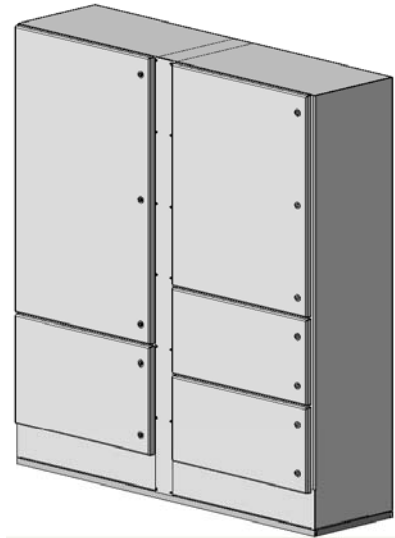
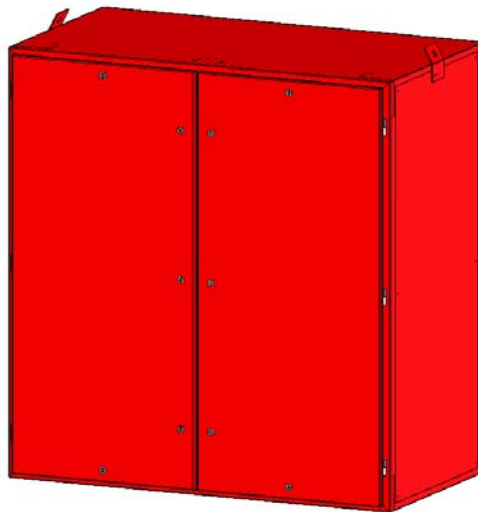
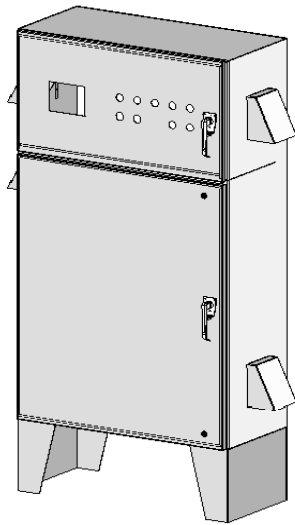



Conditions Of Sale

Specialty Orders, custom orders, delivery:

All shipping dates are based on the estimated amount of time required to process the order commencing with the date the order is taken, pending point 4 below. Should it be necessary to revise the specifications or conditions of sale for any reason whatsoever outside of the control of Code Electric Products Ltd. (herein called Code) the purchaser will acknowledge that the shipping date shall be extended by a period of time needed to achieve the said changes. At no time shall the purchaser hold Code responsible for any delay or damages incurred due to acts of God, priorities, orders or restrictions imposed by Government, delays in transport, delays from our suppliers or delays due to labour and all delays beyond the control of Code.

1. Every order for special material requires an approval drawing. The approval drawing is to be designed by Code for production, and based on Code's interpretation and tolerance levels.
2. This Code drawing is to be **verified** and **signed** by the **customer and the distributor** for production purposes.
3. Please note that **all revisions** require a **new approval**. This new drawing must also be signed by **both parties** and the **revisions must be kept on file by the distributor**.
4. No manufacturing will commence unless the **customer and distributor** have signed the Code drawing and stipulated the Code drawing number(s) and latest revision.
5. All purchase orders must clearly indicate the latest revision drawing number.

Warranty

All products, other than Eurobex which have their own warranty terms detailed in the Eurobex price list, are warranted to be free from defects in material and workmanship for a period of 1 year from date of shipment from the Code plant. In the event that a product is proven to be defective to Code or Eurobex such product shall be repaired or replaced at the option of the said companies. This repair or replacement shall constitute a fulfillment of all liabilities with respect to such goods. At no time, and under no circumstances will a credit be issued for unauthorized rework on any materials, and all charges associated with a return for defective products deemed non-defective shall be charged to the purchaser. Code shall not be liable for damages to goods or property of persons due to improper installation or if the materials purchased are subject to conditions which exceed design capabilities.

Minimum Billing

Minimum billing is **\$125.00** net of transport and taxes.

Quotation & Pricing:

Goods will be billed at the price effective at the time of order. Code reserves the right to cancel or adjust prices and delivery date.

Freight Terms:

All products are shipped F.O.B. our plant, Coquitlam, British Columbia. Freight prepaid on standard items shipped via the carrier of choice by Code providing the order meets the prepaid minimum detailed below, NET pricing, taxes not included. Additional shipping charges may be incurred when special equipment is requested, e.g.: flat beds, open sides, lift gates. **Prepaid shipping from our plant to a distributor location within BC only.**

Shipping Prepaid Minimums:

BC (excluding the lower mainland includes Chilliwack): \$1250.00 ppd. minimum on standard or custom product.
 BC lower mainland (Vancouver to Abbotsford excludes Chilliwack): \$900.00 ppd. minimum on standard product.

Prepaid shipping from our plant to a distributor location within BC only.

*Exceptions: Single piece Eurobex enclosures weighing more than 250 lbs each are subject to a freight surcharge.

Order Cancellation:

Orders may be cancelled only with Code's written approval.

Returned Goods:

Only unused Code products in new condition and no more than one year old will be considered for return. Upon approval and issue of an RMA (Return merchandise authorization) products may be returned for exchange for other products of equal value. All returns are to be prepaid and must be pre-authorized. Custom, modified or specialty products are non returnable.

Transport Policy:

1. Our products are always shipped F.O.B. our plant, Coquitlam, British Columbia regardless of freight payment terms.
2. F.O.B. "freight on board" denotes that title to the shipment passes to the purchaser at the instant that the carrier signs the bill of lading. It is the responsibility of the purchaser to ensure that the shipment is received in good order, and, to file a **Damaged in Transport Claim** with the carrier should there be damages. Code is not responsible for any liability arising thereof, and cannot be involved in any recovery process.
3. Code will not accept any return shipment due to **Transport Damages** unless authorized.
4. Should repair or replacement of goods be necessary a new Purchase Order must be issued to Code. Code will authorize a return to our plant, with transport at the purchaser's expense. The purchaser is responsible for payment of **both purchase orders**.